

**SCHOOL SAFETY INITIATIVE**

**By**



**Revenue and Disaster Management Department**

**Government of Haryana**

**SCHOOL DISASTER MANAGEMENT PLAN**

**MODEL TEMPLATE**

**2015-16**

---



**CENTRE FOR DISASTER MANAGEMENT**

**HARYANA INSTITUTE OF PUBLIC ADMINISTRATION**

**GURGAON**

**INDEX**

1. School Profile
  - 1.1. School Details
  - 1.2. School Building Details
  - 1.3. Details of Students
2. Hazard Risk, Vulnerability and Capacity (HRVC) Assessment
  - 2.1. Detailed history of Hazards/Accidents in School
  - 2.2. Risk Analysis
  - 2.3. Identification of Potential Non-Structural Hazards
  - 2.4. Identification of Vulnerable Population
  - 2.5. Capacities
    - 2.5.1. Skilled/Trained Human Resource
    - 2.5.2. Resource Inventory
3. Response Mechanism
  - A. School Disaster Management Committee (SDMC)
  - B. Teams Under SDMC
    1. Early warning, Communication & Awareness Generation Team
    2. Evacuation Team
    3. Fire Safety Team
    4. Search and Rescue Team
    5. First Aid Team
    6. Water and Sanitation Team
    7. Road Safety Team
    8. Coordination Team
4. Evacuation Plan with Evacuation Map
5. Mock Drill
6. Assessment check list

## 1. School Profile

### 1.1 School Details

|     |                                  |               |                      |                       |                           |
|-----|----------------------------------|---------------|----------------------|-----------------------|---------------------------|
| 1.  | Name of the School               |               | GSSS DHUKRA          |                       |                           |
| 2.  | School Code                      |               | 2905                 |                       |                           |
| 3.  | Address                          |               | DHUKRA               |                       |                           |
|     |                                  |               | PO-JAMAL             |                       |                           |
|     |                                  |               | ELLENABAD            |                       |                           |
|     |                                  |               | SIRSA                |                       |                           |
|     |                                  | Telephone     |                      |                       |                           |
|     |                                  | Fax           |                      |                       |                           |
|     |                                  | Email         | gsssdhukra@yahoo.com |                       |                           |
| 4.  | Name of the Principal            |               | SH sahi ram          |                       |                           |
| 5.  | Contact Details                  |               | Telephone            |                       |                           |
|     |                                  |               | Mobile               |                       |                           |
|     |                                  |               | Email                | 9416413263            |                           |
| 6.  | Type of School                   |               | <b>Co-ed.</b>        |                       |                           |
|     |                                  |               | <b>Hindi /</b>       |                       |                           |
| 7.  | School Timings                   |               | 8:00 AM to 2:30 PM   |                       |                           |
| 8.  | Total Students                   |               | Boys:194             | Total: 411            |                           |
|     |                                  |               | Girls: 217           |                       |                           |
| 9.  | Teaching Staff                   |               | Male:17              | Total: 20             |                           |
|     |                                  |               | Female:3             |                       |                           |
| 10. | Non-Teaching Staff               |               | Male:4               | Total: 5              |                           |
|     |                                  |               | Female:1             |                       |                           |
| 11. | No. of differently abled persons |               | <b>Students</b>      | <b>Teaching staff</b> | <b>Non teaching staff</b> |
|     |                                  | <b>Male</b>   | 1                    | 0                     | 0                         |
|     |                                  | <b>Female</b> | 1                    | 0                     | 0                         |
|     |                                  | <b>Total</b>  | 2                    | 0                     | 0                         |

**1.1.1 Details of Teaching Staff –permanent and contractual (add additional sheet if needed):**

| <b>Sr. No.</b> | <b>Name</b>    | <b>Blood Group</b> | <b>Age</b> | <b>Sex</b> | <b>Medical Concerns like Asthma, Diabetes, BP etc.)</b> | <b>Disability if any</b> | <b>Standard &amp; Subject they teach</b> | <b>Contact No.</b> | <b>Residential Address</b> |
|----------------|----------------|--------------------|------------|------------|---|--------------------------|--|--------------------|----------------------------|
| 1              | SAHI RAM       |                    | 50         | M          | NO  | NO                       | PRINCIPAL                                | 9416413263         | sirsa                      |
| 2              | RITESH         |                    | 28         | M          | NO  | NO                       | LECT                                     | 9468052381         | sirsa                      |
| 3              | RAJESH KUMAR   |                    | 47         | M          | NO  | NO                       | LECT                                     | 9468313396         | sirsa                      |
| 4              | SAROJ DEVI     |                    | 43         | F          | NO  | NO                       | LECT                                     |                    | sirsa                      |
| 5              | VINOD KUMAR    |                    | 32         | M          | NO  | NO                       | LECT                                     | 9992608044         | JAMAL                      |
| 6              | PRIYANKA       |                    | 35         | F          | NO  | NO                       | LECT                                     |                    | sirsa                      |
| 7              | RAMESH KUMAR   |                    | 51         | M          | NO  | NO                       | ELE MIDD<br>HEAD                         | 9466090524         | sirsa                      |
| 8              | SUDHIR KAUSHIK |                    | 45         | M          | NO  | NO                       | DPE                                      | 9416216286         | sirsa                      |
| 9              | RITU VERMA     |                    | 29         | F          | NO  | NO                       | MATH                                     | 9354267290         | sirsa                      |
| 10             | JAIDEEP SINGH  |                    | 42         | M          | NO  | NO                       | SCI                                      | 9416921227         | sirsa                      |
| 11             | BHUP SINGH     |                    | 46         | M          | NO  | NO                       | SS                                       |                    | JAMAL                      |
| 12             | BHARAT SINGH   |                    | 49         | M          | NO  | NO                       | SS                                       |                    | JAMAL                      |
| 13             | RADHE SHYAM    |                    | 50         | M          | NO  | NO                       | SS                                       | 9466668935         | JAMAL                      |
| 14             | CHANAN RAM     |                    | 31         | M          | NO  | NO                       | DRAWING                                  | 9812401503         | DHINGTANIA                 |
| 15             | MADAN LAL      |                    | 40         | M          | NO  | NO                       | PTI                                      |                    | DHINGTANIA                 |
| 16             | SATYA NARAIN   |                    | 45         | M          | NO  | NO                       | HINDI                                    | 9416146069         | sirsa                      |
| 17             | PARAS RAM      |                    | 50         | M          | NO  | NO                       | SANSKRIT                                 |                    | sirsa                      |



## 1.2 School Building Details

|   |  |   |               |                            |                                |                 |                  |              |                      |                       |                      |                     |                              |
|---|--|---|---------------|----------------------------|--------------------------------|-----------------|------------------|--------------|----------------------|-----------------------|----------------------|---------------------|------------------------------|
| 1 | Number of Storey   | Basement  | (NO)          |                            |                                |                 |                  |              |                      |                       |                      |                     |                              |
|   |  | Storey  | NO            |                            |                                |                 |                  |              |                      |                       |                      |                     |                              |
| 2 | Year of Construction<br>(Give details if constructed in parts) | 1976,2013   |               |                            |                                |                 |                  |              |                      |                       |                      |                     |                              |
| 3 | Number of buildings in the school compound:                    | 3   |               |                            |                                |                 |                  |              |                      |                       |                      |                     |                              |
| 4 | <b>Class Rooms</b>   | <b>Number of:</b>   |               |                            |                                |                 |                  |              |                      |                       |                      |                     |                              |
|   |  | <b>Class Rooms</b>  | <b>Office</b> | <b>Teaching Staff Room</b> | <b>Non-teaching Staff Room</b> | <b>Corridor</b> | <b>Staircase</b> | <b>Store</b> | <b>Toilet (Boys)</b> | <b>Toilet (Girls)</b> | <b>Computer Lab.</b> | <b>Laboratories</b> | <b>Drinking water points</b> |
|   | Ground Floor   | 12  | 1             | 1                          |                                | 1               |                  |              | 2                    | 2                     | 1                    | 1                   | 1                            |
|   | 1 <sup>st</sup> Floor  | 0   | 0             | 0                          | 0                              | 0               | 0                | 0            | 0                    | 0                     | 0                    | 0                   | 0                            |
|   | 2 <sup>nd</sup> Floor  | 0   | 0             | 0                          | 0                              | 0               | 0                | 0            | 0                    | 0                     | 0                    | 0                   | 0                            |
|   | 3 <sup>rd</sup> Floor  | 0   | 0             | 0                          | 0                              | 0               | 0                | 0            | 0                    | 0                     | 0                    | 0                   | 0                            |
|   | 4 <sup>th</sup> Floor  | 0   | 0             | 0                          | 0                              | 0               | 0                | 0            | 0                    | 0                     | 0                    | 0                   | 0                            |
|   | <b>Total</b>   | 12  | 1             | 1                          |                                | 1               |                  |              | 2                    | 2                     | 1                    | 1                   | 1                            |
| 5 | Do you have a kitchen?   | YES WITH SHED   |               |                            |                                |                 |                  |              |                      |                       |                      |                     |                              |
| 6 | Playground size and open ground                                | 25*10 METER   |               |                            |                                |                 |                  |              |                      |                       |                      |                     |                              |
| 7 | School Maps  | <ol style="list-style-type: none"> <li>1. Attach School Location Map (showing major landmarks)</li> <li>2. Attach School Building Map (showing school campus and building layout)</li> <li>3. Attach School Floor Maps (showing floor wise layout)</li> </ol> |               |                            |                                |                 |                  |              |                      |                       |                      |                     |                              |

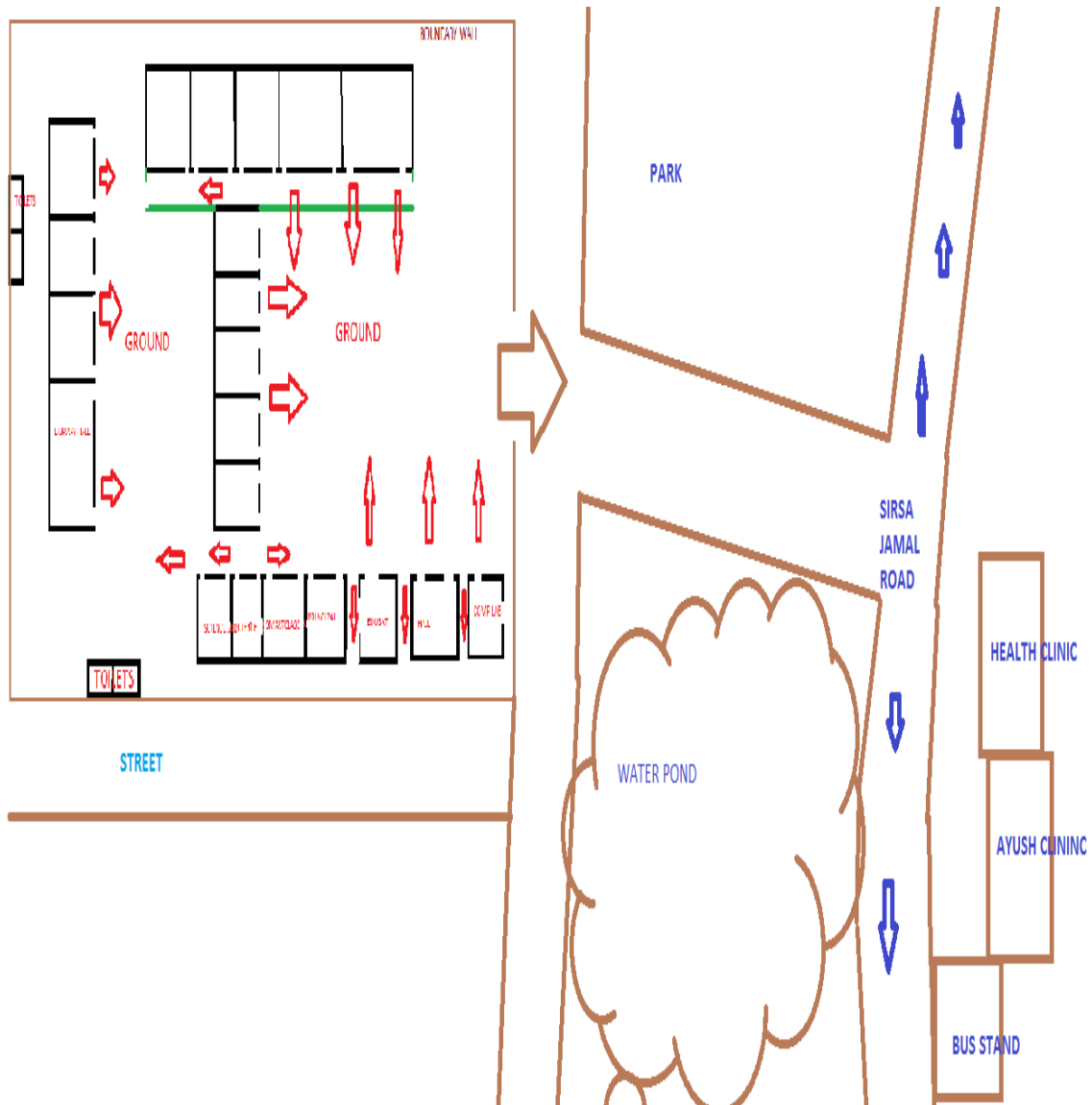

### 1.3 Details of Students:

| Class           | Section | Boys | Girls | Total | Person with medical concern | PERSON WITH DIASABILITY |
|-----------------|---------|------|-------|-------|-----------------------------|-------------------------|
| 1 <sup>st</sup> | A       |      |       |       |                             |                         |
|                 | B       |      |       |       |                             |                         |
|                 | C       |      |       |       |                             |                         |
|                 | D       |      |       |       |                             |                         |
| 2 <sup>nd</sup> | A       |      |       |       |                             |                         |
|                 | B       |      |       |       |                             |                         |
|                 | C       |      |       |       |                             |                         |
|                 | D       |      |       |       |                             |                         |
| 3 <sup>rd</sup> | A       |      |       |       |                             |                         |
|                 | B       |      |       |       |                             |                         |
|                 | C       |      |       |       |                             |                         |

|                  |   |    |    |    |  |   |
|------------------|---|----|----|----|--|---|
| 4 <sup>th</sup>  | D |    |    |    |  |   |
|                  | A |    |    |    |  |   |
|                  | B |    |    |    |  |   |
|                  | C |    |    |    |  |   |
| 5 <sup>th</sup>  | D |    |    |    |  |   |
|                  | A |    |    |    |  |   |
|                  | B |    |    |    |  |   |
|                  | C |    |    |    |  |   |
| 6 <sup>th</sup>  | D |    |    |    |  |   |
|                  | A | 17 | 18 | 35 |  | 1 |
|                  | B | 21 | 20 | 41 |  |   |
|                  | C |    |    |    |  |   |
| 7 <sup>th</sup>  | D |    |    |    |  |   |
|                  | A | 23 | 21 | 44 |  | 1 |
|                  | B | 21 | 19 | 40 |  |   |
|                  | C |    |    |    |  |   |
| 8 <sup>th</sup>  | D |    |    |    |  |   |
|                  | A | 20 | 17 | 37 |  |   |
|                  | B | 21 | 22 | 43 |  |   |
|                  | C |    |    |    |  |   |
| 9 <sup>th</sup>  | D |    |    |    |  |   |
|                  | A | 11 | 15 | 26 |  |   |
|                  | B | 10 | 15 | 25 |  |   |
|                  | C |    |    |    |  |   |
| 10 <sup>th</sup> | D |    |    |    |  |   |
|                  | A | 19 | 23 | 42 |  |   |
|                  | B |    |    |    |  |   |
|                  | C |    |    |    |  |   |
| 11 <sup>th</sup> | D |    |    |    |  |   |
|                  | A | 21 | 21 | 42 |  |   |
|                  | B | 10 | 26 | 36 |  |   |
|                  | C |    |    |    |  |   |
| 12 <sup>th</sup> | D |    |    |    |  |   |
|                  | A | 10 | 26 | 36 |  |   |
|                  | B |    |    |    |  |   |
|                  | C |    |    |    |  |   |

### 1.3.1 Details of Persons With Disability:

| Sr. No. | Name   | Age | Sex | Standard and Section | Type of disability |
|---------|--------|-----|-----|----------------------|--------------------|
| 1       | VIKRAM | 12  | M   | 7                    | PHYSICALLY         |



|   |        |    |   |   |            |
|---|--------|----|---|---|------------|
|   |        |    |   |   | HANICAPPED |
| 2 | SUNITA | 13 | F | 6 | DEAF DUMB  |
|   |        |    |   |   |            |
|   |        |    |   |   |            |
|   |        |    |   |   |            |
|   |        |    |   |   |            |
|   |        |    |   |   |            |
|   |        |    |   |   |            |

**1.3.2 Details of person with medical concern (like Asthma, Diabetes, Cardiac Diseases etc):**

| Sr. No. | Name                | Age | Sex | Standard and Section | Type of medical concern |
|---------|---------------------|-----|-----|----------------------|-------------------------|
|         | <b>no such case</b> |     |     |                      |                         |
|         |                     |     |     |                      |                         |
|         |                     |     |     |                      |                         |
|         |                     |     |     |                      |                         |
|         |                     |     |     |                      |                         |
|         |                     |     |     |                      |                         |
|         |                     |     |     |                      |                         |
|         |                     |     |     |                      |                         |
|         |                     |     |     |                      |                         |

**2. Hazard, Risk, Vulnerability and Capacity (HRVC) Analysis**

**2.1 Detailed History of Disaster/Accidents in School**

| Sr. No. | Disaster/Accidents  | Date & Time of occurrence | Total No. of people affected (injured & dead) |         |
|---------|---------------------|---------------------------|---|---------|
|         |                     |                           | Dead  | Injured |
|         | <b>no such case</b> |                           |   |         |
|         |                     |                           |   |         |
|         |                     |                           |   |         |
|         |                     |                           |   |         |
|         |                     |                           |   |         |

|  |  |  |  |  |
|--|--|--|--|--|
|  |  |  |  |  |
|--|--|--|--|--|

## 2.2 Possible Hazards:

| Hazards<br>(in and around the school) | Hazard Probability<br>(High / Med / Low) | Possible causes        |
|---------------------------------------|--|------------------------|
| Road Accidents                        | <b>Low</b>                               | STUDENT CROSSES ROAD   |
| Flood                                 |  |                        |
| Earthquake                            |  |                        |
| Building collapse                     | med                                      | <b>Dilapidated</b>     |
| Epidemic / Contagious disease         |  |                        |
| Fire                                  |  |                        |
| Heat Wave                             |  |                        |
| Cold Wave                             |  |                        |
| Industrial / Chemical hazard          |  |                        |
| Stampede                              |  |                        |
| Animal Bite                           |  |                        |
| Snake Bite                            | <b>Low</b>                               | GRASS AREA NEAR SCHOOL |
| Food Poisoning                        |  |                        |
| Others (specify)                      |  |                        |

## 2.3 Identification of Potential Structural/Non Structural Hazards

| Sr. No. | Structural/Non Structural Hazards<br>Areas | Location                     |
|---------|--|------------------------------|
|         | <b>Inside School</b>                       |                              |
| 1.      | Gas cylinders                              | NA                           |
| 2.      | Other fuel (petrol/diesel/kerosene etc.)   | NA                           |
| 3.      | Chemical bottles                           | LAB                          |
| 4.      | Main Electrical Boards                     | LAB                          |
| 5.      | Hanging Electrical Wires                   | <u>NA</u>                    |
| 6.      | Suspended Ceilings                         | <u>NA</u>                    |
| 7.      | Unfixed Almirahs/cabinets                  | <b><u>STAFF ROOM LAB</u></b> |

|     |                        |                                    |
|-----|------------------------|------------------------------------|
| 8.  | Unfixed wall Frames    | <b><u>STAFF ROOM</u></b>           |
| 9.  | Doors/ Windows         | <b><u>ROOMS</u></b>                |
| 10. | Open drains/ gutter    | <b><u>NA</u></b>                   |
| 11. | Trees                  | <b><u>IN PLAYGROUND/CAMPUS</u></b> |
| 12. | Defected staircases    | <b><u>NA</u></b>                   |
| 13. | Severely cracked walls | <b><u>IN DILAPIDATED ROOMS</u></b> |
| 14. | Others (specify)       | <b><u>NA</u></b>                   |
|     | <b>Outside School</b>  |                                    |
| 1   | Trees                  | <b><u>NA</u></b>                   |
| 2   | Power Lines            | <b><u>NA</u></b>                   |
| 3   | Towers                 | <b><u>NA</u></b>                   |
| 4   | Others (specify)       | <b><u>POND,VILLAGE ROAD</u></b>    |

#### 2.4 Identification of Vulnerable Population

| Sr. No. | Category                                    | Total No.        |                  |
|---------|---|------------------|------------------|
|         |   | Male             | Female           |
| 1.      | Children below 12 years                     | <b><u>60</u></b> | <b><u>57</u></b> |
| 2.      | Old age people if any                       | <b><u>NA</u></b> |                  |
| 3.      | Students with special medical concerns      | <b><u>NA</u></b> |                  |
| 4.      | Teaching/Non-teaching staff with ill health | <b><u>NA</u></b> |                  |
| 5.      | Others (specify)                            | <b><u>NA</u></b> |                  |

#### 2.5 Capacities

##### 2.5.1 Skilled/Trained Human Resource

| Trained Volunteers    | Boys | Girls | Total | Name of the coordinator | Contact No. of the coordinator |
|-----------------------|------|-------|-------|-------------------------|--------------------------------|
| NCC (Yes/No)          |      |       |       |                         |                                |
| NSS (Yes/No)          |      |       |       |                         |                                |
| Scout & Guide(Yes/No) |      |       |       |                         |                                |

Expertise: Search & Rescue, Fire Safety, First Aid, Swimming, Sports, Foreign Languages (other than English) etc.

| Sr. No | Name of Person | Expertise in | Teacher/ Student | Standard | Contact No. |
|--------|----------------|--------------|------------------|----------|-------------|
|        |                |              |                  |          |             |
|        |                |              |                  |          |             |
|        |                |              |                  |          |             |
|        |                |              |                  |          |             |
|        |                |              |                  |          |             |
|        |                |              |                  |          |             |

### 2.5.2 Resource Inventory

#### A. Equipments within school and also nearby school:

| Sr. No. | List of Items            | Details of the item  | Person Incharge | Contact No. of the person incharge |
|---------|--------------------------|----------------------|-----------------|------------------------------------|
| 1.      | First Aid Kits           | KIT<br>AVAILABLE     | BHUP SINGH      |                                    |
| 2.      | Fire Extinguishers       | YES 1<br>CYLINDER    | JAIDEEP         | 9416921227                         |
| 3.      | Ladder (Nos. and Length) |                      |                 |                                    |
| 4.      | Rope (Nos. and Length)   |                      |                 |                                    |
| 5.      | Stretchers               |                      |                 |                                    |
| 6.      | Torches                  |                      |                 |                                    |
| 7.      | Hammers                  |                      |                 |                                    |
| 8.      | Generators / UPS         | YES NEAR<br>COMP LAB | JAGDISH         | 9467295691                         |
| 9.      | Others                   |                      |                 |                                    |

#### B. Communication Set up

| Sr. No | Type of System                           | Total No  |
|--------|--|-----------|
| 1      | Wireless sets (if nearby Police Station) | <u>NA</u> |
| 2      | Landline telephone                       | <u>NA</u> |
| 3      | Internet Facility                        | <u>NA</u> |

|   |       |           |
|---|-------|-----------|
| 4 | Fax   | <u>NA</u> |
| 5 | Other |           |

### C. Transport Facilities

| Sr. No | Type of Vehicle            | Total No  |
|--------|----------------------------|-----------|
| 1      | School Bus (with capacity) | <u>NA</u> |
| 2      | 4 wheelers (personal)      | 3         |
| 3      | 2 wheelers (personal)      | 3         |
| 4      | Other vehicles             | <u>NA</u> |

### D. Nearest Resources

| Sr. No | Nearest Resource              | Distance in Kms | Contact no | Address     |
|--------|-------------------------------|-----------------|------------|-------------|
| 1      | Police Station/Police Post    | 5               |            | JAMAL       |
| 2      | Fire Station                  | 25              |            | SIRSA       |
| 3      | Primary Health Centre (PHC)   | 0.200           |            | DHUKRA      |
| 4      | Community Health Centre (CHC) | 20              |            | N CHOPPTA   |
| 5      | Hospital (Public)             | 20              |            | N CHOPTA    |
| 6      | Hospital (Private)            | 20              |            | N CHOPTA    |
| 7      | Ambulance Services            | 20              |            | N CHOPTA    |
| 8      | District Control Room         | 25              |            | SIRSA       |
| 9      | Other Schools                 | 3               |            | GUUDIAKHERA |
| 10     | Others                        |                 |            |             |

## 3. Response Mechanism

### A. Roles and Responsibility of School Disaster Management Committee (SDMC)

- Help school in preparation & evaluation of DM Plan
- Look into structural safety of school
- Work out financial aspects of preparedness & mitigation measures.
- Arrange conduct of Mock Exercises on various types of disasters twice a year.

During disaster, help in coordinating various groups and teams

**Suggested list for School Disaster Management Committee**

| <b>Sr. No.</b> | <b>Designation</b>  | <b>Role in SDMC</b> |
|----------------|---|---------------------|
| 1.             | Principal/Head of the school (Compulsory)   | Chairperson         |
| 2.             | Senior Lecturer/Teacher (Compulsory)  | Vice Chairperson    |
| 3.             | Member from SMC (Compulsory)  | Member              |
| 4.             | Senior Lady teacher (Compulsory)  | Member              |
| 5.             | Parent Teacher Association Head (Compulsory)  | Member              |
| 6.             | 4 students (NCC, NSS, Scouts and Guides, Head Boy and Head Girl)  | Member              |
| 7.             | Representative from Revenue and Disaster Management Department/District Administration/ Municipal Corporation | Member              |
| 8.             | Representative from Fire Services (from closest Fire Station)   | Member              |
| 9.             | Representative from Police department (from closest Police Station)   | Member              |
| 10.            | Representative from Health Department (local Doctor)  | Member              |
| 11.            | A warden from Civil Defence   | Member              |
| 12.            | Representative from Panchayat   | Member              |
| 13.            | Representative from NGOs  | Member              |

**School Disaster Management Committee**

| <b>Sr. No.</b> | <b>Name</b>  | <b>Designation</b>                           | <b>Designation in SDMC</b> | <b>Contact No</b> | <b>Residential Address</b> |
|----------------|--------------|--|----------------------------|-------------------|----------------------------|
| 1              | SAHI RAM     | Principal/Head of the school (Compulsory)    | Chairperson                | 9416413263        | SIRSA                      |
| 2              | RAJESH KUMAR | Senior Lecturer/Teacher (Compulsory)         | Vice Chairperson           | <b>9468313396</b> | SIRSA                      |
| 3              | JASWANT      | Member from SMC (Compulsory)                 | Member                     |                   | DHUKRA                     |
| 4              | SAROJ        | Senior Lady teacher (Compulsory)             | Member                     | 9416311119        | SIRSA                      |
| 5              | SATYA NARAIN | Parent Teacher Association Head (Compulsory) | Member                     | 9416146069        | SIRSA                      |
| 6              |              |  |                            |                   |                            |
| 7              |              |  |                            |                   |                            |
| 8              |              |  |                            |                   |                            |
| 9              |              |  |                            |                   |                            |
| 10             |              |  |                            |                   |                            |
| 11             |              |  |                            |                   |                            |

|    |  |  |  |  |  |
|----|--|--|--|--|--|
| 12 |  |  |  |  |  |
| 13 |  |  |  |  |  |

## B. Teams Under SDMC

### 1. Early warning, Communication & Awareness Generation Team

#### Composition

- Geography Teacher
- Art & Craft Teacher.
- Drama & Music Teacher.
- 1-2 parents (working with media/NGO)
- 1-2 students (good speaker & creative).

#### Roles and responsibilities:

- Keep track on weather reports, Hazard information
- Generate early warning based on relevant information
- Maintain communication before, during and after disasters within and outside the school.
- Conduct awareness programs. (Through IEC material, Rally, School level drawing/debate competitions, Street play, Exhibitions, Hoardings, Audio Visual Show etc).
- Conduct training programs by bringing in experts.
- Display of evacuation routes at different critical location.
- Display of emergency numbers for various departments.

| Sr. No | Name         | Sex | Standard | Contact No. | Residential Address |
|--------|--------------|-----|----------|-------------|---------------------|
| 1      | CHANAN RAM   | M   | HIGH=10  |             | DHINGTANIA          |
| 2      | SATISH KUMAR | M   | HIGH=10  |             | SIRSA               |
| 3      |              |     |          |             |                     |
| 4      |              |     |          |             |                     |
| 5      |              |     |          |             |                     |

## 2. Evacuation Team

### Composition

- All class teachers.
- Class monitors & hall monitor.

### Roles and responsibilities:

- Identify safer locations and routes.
- Prepare school location map and floor maps of the school
- Prepare evacuation plan in consultation with school
- Practice Duck, Cover & Hold at first sign of earthquake.
- Evacuate in an orderly manner, in buddy system, with monitor leading & teacher bringing the last buddies along designated evacuation route.

| Sr. No | Name         | Sex | Standard | Contact No. | Residential Address |
|--------|--------------|-----|----------|-------------|---------------------|
| 1      | BHUP SINGH   | M   | 10       |             | SIRSA               |
| 2      | RADHESHYAM   | M   | 10       |             | SIRSA               |
| 3      | CHANAN RAM   | M   | 10       |             | SIRSA               |
| 4      | RAMESH KUMAR | M   | 10       |             | DHUKRA              |
| 5      | RAVI KUMAR   | M   | 12       |             | JAMAL               |

## 3. Fire Safety Team

### Composition

- Teachers (2)
- 1-2 parents (from fire services/ Defence/Para Military services/civil defence)
- Students trained in fire safety.

### Roles and responsibilities:

- Proper maintenance of fire extinguishers. (Check the expire date)
- Ensuring proper fire extinguishers for proper site.
- Monitoring the electric supply points.



- Switch of the main power if possible.
- Members of this team should be able to carry and use fire extinguishers.

| Sr. No | Name         | Sex | Standard         | Contact No. | Residential Address |
|--------|--------------|-----|------------------|-------------|---------------------|
| 1      | RITESH KUMAR | M   | 10 <sup>TH</sup> | 9468052381  | SIRSA               |
| 2      | JAIDEEP      | M   | 12 <sup>TH</sup> | 9416921227  | SIRSA               |
| 3      |              |     |                  |             |                     |
| 4      |              |     |                  |             |                     |
| 5      |              |     |                  |             |                     |

#### 4. Search and Rescue Team

##### Composition

- Sports/PT teacher
- NCC/NSS/Scouts & Guides Teacher.
- Fire Services representative
- CD Trainer.
- 1-2 parents (from uniformed forces)
- Able bodied students

##### Roles and responsibilities:

- After everyone is out take a round around the campus to see if anybody is left behind. (Note: not to go near the effected of danger zone).
- If there is a heavy earthquake situation, the team is not to go inside but to take a round from a safe distance from the building and call the emergency response team.
- If any students are trapped identify if possible the areas where they are trapped.
- Brief the Emergency Response Team about the situation.

| Sr. No | Name           | Sex | Standard         | Contact No. | Residential Address |
|--------|----------------|-----|------------------|-------------|---------------------|
| 1      | SUDHIR KAUSHIK | M   | 12 <sup>TH</sup> |             | SIRSA               |
| 2      | MADAN LAL      | M   | 10 <sup>TH</sup> |             | DHINGTANIA          |
| 3      |                |     |                  |             |                     |
| 4      |                |     |                  |             |                     |

|   |  |  |  |  |  |
|---|--|--|--|--|--|
| 5 |  |  |  |  |  |
|---|--|--|--|--|--|

## 5. First Aid Team

### Composition

- School doctor.
- School Nurse.
- St. John/Red Cross volunteers.
- Anganwadi workers/ANM
- 1-2 parents (doctors)
- Students trained in first aid.

### Roles and responsibilities:

- Administer first aid and record all cases & treatment.
- Accompany search & rescue teams during search.
- Help in evacuating seriously injured.
- Aid the physically handicapped.

| Sr. No | Name | Sex | Standard | Contact No. | Residential Address |
|--------|------|-----|----------|-------------|---------------------|
| 1      |      |     |          |             |                     |
| 2      |      |     |          |             |                     |
| 3      |      |     |          |             |                     |
| 4      |      |     |          |             |                     |
| 5      |      |     |          |             |                     |

## 6. Coordination Team

### Composition

- Members from SDMC
- NCC/NSS/Scouts & Guides Coordinator.
- School Monitor

### Roles and responsibilities:

- Over all coordination of activities under SDMC
- Facilitate and coordinate with other teams.
- To avoid chaos during disasters.

- Systematically move the students to the safety zone.
- If it is an earthquake situation, make them wait in the classrooms and instruct them to be under the table till the tremors are over.

| Sr. No | Name | Sex | Standard | Contact No. | Residential Address |
|--------|------|-----|----------|-------------|---------------------|
| 1      |      |     |          |             |                     |
| 2      |      |     |          |             |                     |
| 3      |      |     |          |             |                     |
| 4      |      |     |          |             |                     |
| 5      |      |     |          |             |                     |

## 7. Water and Sanitation Team

### Composition

- Science Teacher
- NCC/NSS/Scouts & Guides students.

### Roles and responsibilities:

- To ensure safe drinking water to everybody.
- Proper maintenance of the available water resources.
- Cleanliness of the school and surrounding campus.
- Use of mosquito repellent chemicals.
- Ensure hygienic toilets

| Sr. No | Name          | Sex | Standard         | Contact No. | Residential Address |
|--------|---------------|-----|------------------|-------------|---------------------|
| 1      | JAIDEEP SINGH | M   | 10 <sup>TH</sup> | 9416921227  | SIRSA               |
| 2      | RITESH KUMAR  | M   | 12 <sup>TH</sup> | 9468052381  | SIRSA               |
| 3      |               |     |                  |             |                     |
| 4      |               |     |                  |             |                     |
| 5      |               |     |                  |             |                     |

## 8. Bus/Road Safety Team

### Composition

- Teacher (traveling in respective buses).
- Student getting down at last stop.
- One senior most student in bus.

### Roles and responsibilities:

- Pull over to side of road, if possible in open.
- Instruct passengers to crouch down between seats and in aisle until shaking stops, move out and stay till contact with DM department/school authorities.
- Ensure special need students are assisted.
- Assist giving first aid to injured students.
- Establish communication with school Control Room.

| Sr. No | Name         | Sex | Standard | Contact No. | Residential Address |
|--------|--------------|-----|----------|-------------|---------------------|
| 1      | NO SUCH CASE |     |          |             |                     |
| 2      |              |     |          |             |                     |
| 3      |              |     |          |             |                     |
| 4      |              |     |          |             |                     |
| 5      |              |     |          |             |                     |

#### 4. Evacuation Plan

The evacuation team will identify the safer locations, safe evacuation routes, locations of the equipment like fire extinguishers, fire hydrant points, First-Aid kits etc. in the school and will mark on the floor maps and will prepare floor wise evacuation plan. Display maps prominently at the notice board at each of the floor.

Sample Floor Map showing safe evacuation routes

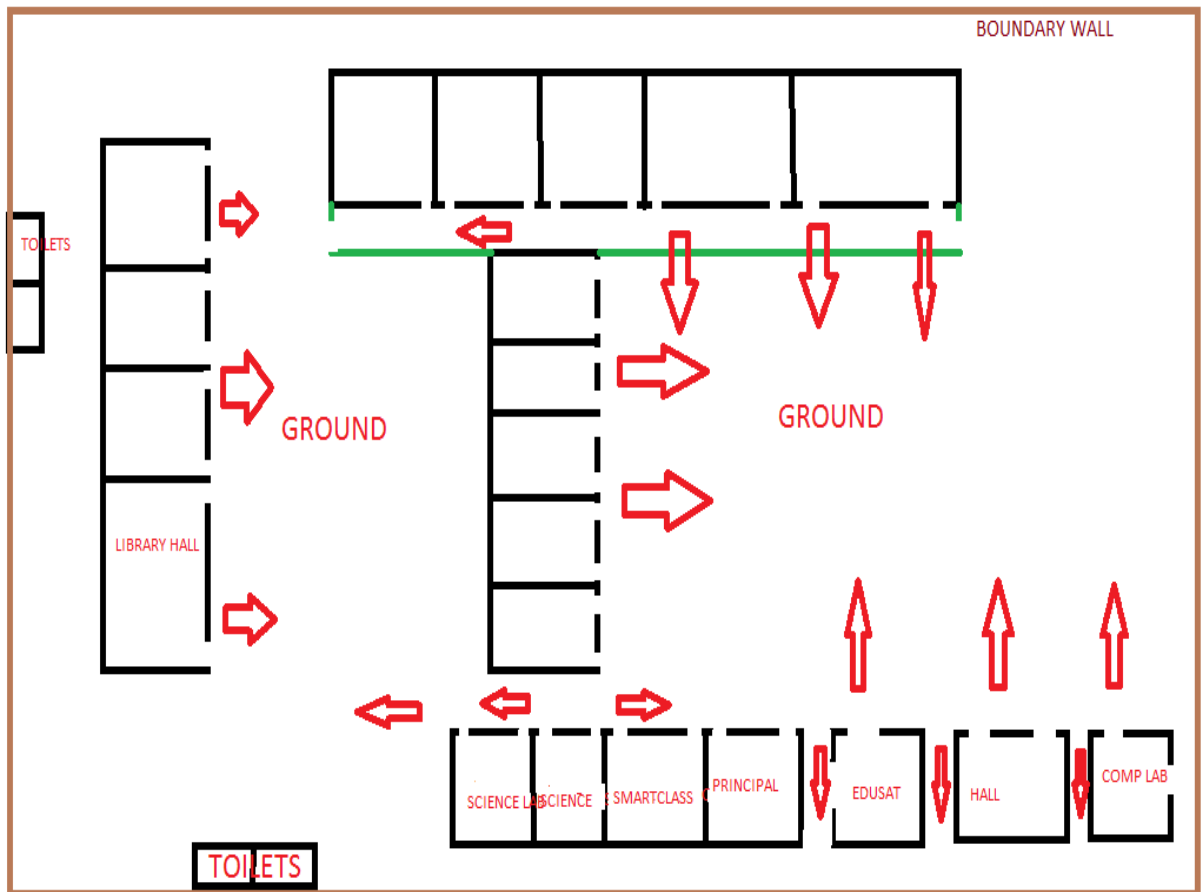

## **5. Mock-Drill**

Mock drills are the way of testing the School Disaster Management Plan. The mock drill on earthquake, fire, etc. should be conducted once in every six months, and the deficiencies should be assessed for the purpose of updation of the plan. This section of the plan should clearly indicate the steps to be followed to conduct the mock drills and the responsibilities of the teachers, non-teaching staff and students should be delineated. If required, the school should invite the Fire Service Officers, doctors from Health Department, trainers from Red-Cross Society trained Civil Defence volunteers and volunteers from NGOs for support in conducting the mock drills.

### **Earthquake drill:**

1. Practice drop, cover and hold.
2. Once evacuation starts, evacuate classroom in less than 1 minute without pushing and falling.
3. Evacuate school in less than 4 minutes using different exits.
4. Look out for friends.
5. Stay away from weak areas / structures.
6. Perform head counts when reach at assembly area.
7. Help those who need assistance

### **Fire Drill:**

1. Evacuate from classroom.
2. Practice Stop, Drop and Roll in case your clothes catch fire.
3. Cut off electricity from main switch and remove or close down gas connections.
4. Evacuate classroom in less than 1 minute without pushing and falling.
5. In case of heavy smoke, crawl out safely from the classroom.
6. Evacuate school in less than 4 minutes using different exits/fire exits.
7. Look out for friends.
8. Perform head counts when reach at assembly area.
9. Help those who need assistance.

**MOCK DRILL WAS HELD IN 2013-14 SESION FOR EARTHQUAKE AND FIRE**

## 6. Assessment check list

### A. Fire Safety Assessment

1. Are fire extinguishers installed in the school? YES
2. Are they in working condition? YES
3. Are students and teachers trained to use fire extinguishers? TEACHER
4. Are they located at appropriate positions (hazardous locations)? YES
5. Are they placed at appropriate height (accessible height)? YES
6. Are instructions indicated on extinguishers? YES
7. Is the language of instructions understood by students and teachers? YES
8. Is hydrant point in the school?
9. Are there Sand Buckets in the school? (specify in Numbers)
10. Are there Water Buckets in the school? (specify in Number)
11. Is emergency fire fighting training and SOP disseminated to the students & teachers?
12. Are do's and don'ts displayed at appropriate locations? NO
13. Are emergency contact numbers displayed at appropriate locations? NO
14. Are school maps and escape routes displayed at appropriate locations in the school?  
YES
15. Is the emergency exit door present in the school? YES
16. Do you dispose flammable scrap at proper sight regularly? YES
17. Are the Fire Safety Norms followed in the school? YES
18. Is fire safety audit conducted annually? NOT ANNUALLY  
(Attach fire safety audit report)

### B. Electrical Safety Assessment

1. Is the central shutdown system in place? YES
2. Has the MCB system been installed? YES
3. Are the wires coated with insulating material? YES
4. Are receptacles installed to cover live wires? YES
5. Are electrical equipments and wires checked and replaced (if required) at every six months? YES

6. Are those equipments which get heated, installed at least 1 meter away from any kind of combustible material? YES

7. Is the earthing properly done in the school? YES

8. Is any defective electrical equipment in use in the school?

Specify:NO

9. Are there any lives wires lying or tangled in open?NO

10. Is any plug point used for multiple loads?NO

Specify at how many points:

(Attach electric safety audit report)

### **C. Non Structural Safety assessment**

1. Are the cabinets/*almirahs* placed away from exit doors? YES

2. Are cabinets/*almirahs* properly fixed to the wall? YES

3. Are these cabinets/*almirahs* empty on the top?NO

4. Are desk placed with proper distance between them for easy movement?

5. Are evacuation routes, passages and stairways clear from obstacles (like flower pots, cupboards, bookshelves, big dustbins etc.) for evacuation? YES

6. Are fans and lights secured with ceiling? YES

7. Are bottles used for storing the chemicals in laboratories secured and protected against shattering? YES

### **D. Structural Safety assessment**

1. How old is school building?APPROX 40YRS, 1BUILDING IN 2013

2. Is building structure earthquake resistant?

3. Is there any portion in the building which shows sign of cracks? YES

If yes, specify the locations MIDST BUILDING(5 ROOMS)

4. Are the Building Safety Norms followed in the school?

5. Has the building safety audit conducted by the structural engineer?

(Attach building safety audit report)



